

## Upgradeable. Long Lifespan. Heavy Duty.

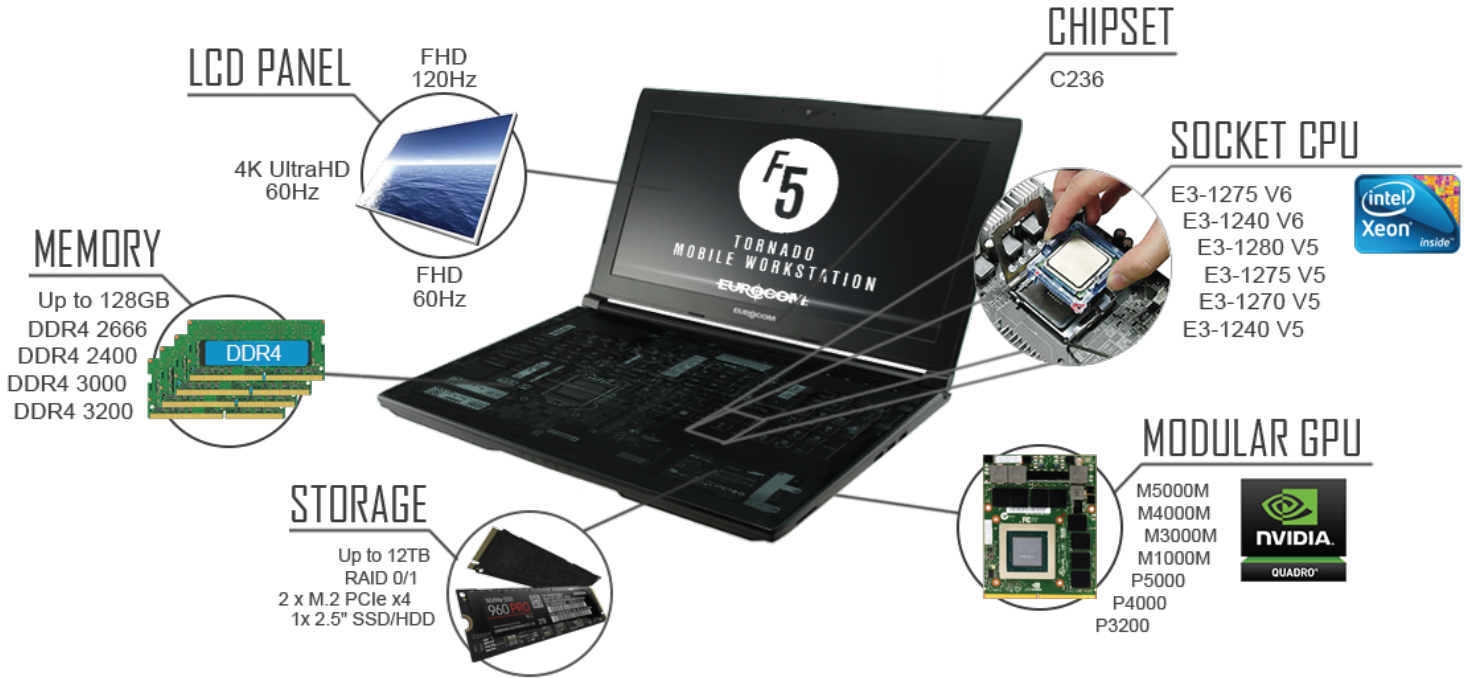

Eurocom Workstations are designed for long lifespan and high performance computing by the most demanding applications and users. With unrivaled power, unsurpassed features and unmatched style, this Workstation Laptop is designed to replace your traditional desktop based workstation computer. Our Workstations are designed for heavy-duty computing so they are built like heavy-duty trucks – portable, easy to move around yet extremely powerful with maximum upgradeability, expandability, and reliability.

## SPEC HIGHLIGHTS

<b>CHIPSET</b>	Intel C236 (Xeon based)
<b>PROCESSOR</b>	XEON E3-1200 V5/V6 series; socket based; LGA1151; up to 91W TDP
<b>GRAPHICS</b>	upgradeable MXM 3.0, up to 150W TDP; discrete GPU only (no Optimus) NVIDIA Quadro: M1000M, M3000M, M4000M, M5000M, P3200, P3000, P4000 or P5000
<b>MEMORY</b>	up to 64GB; four 260-pin SODIMM sockets; DDR4-2133/2400/3000/3200
<b>STORAGE</b>	up to 12TB of storage with 3 physical drive 2x M.2 PCIe x2/x4 (NVMe) or SATSSD + 1x HDD/SSD (9.5mm) SATA3 6Gb/s
<b>OS</b>	Microsoft Windows: 10, 8.1 and 7
<b>NETWORK</b>	1Gb Ethernet LAN on-board; Killer/Rivet E2400,WLAN /Bluetooth; M.2 2230 slot
<b>I/O PORTS</b>	3x USB 3.0; 1x USB 3.1 type C (Thunderbolt 3); 1x DP 1.2; 1x HDMI 2.0; 1x Headphone; 1x Microphone-in; 1x S/PDIF (digital); 1x Line-in; 1x RJ-45 LAN; 1x DC-in
<b>SECURITY</b>	Kensington Lock

